

NOTES:

1. MATERIAL: 3" CARBON STEEL PIPE. MTR'S AVAILABLE UPON REQUEST.
2. TOTAL BOLLARD HEIGHT SHALL BE PROVIDED BY CUSTOMER.

SPECIFICATIONS:

PIPE SCHEDULE: 40 80

A-DIM.: _____

CAP STYLE: FLAT DOME

POWDER COAT COLOR:

SAFETY YELLOW, RAL1023

JET BLACK, RAL 9005

RAL#: _____

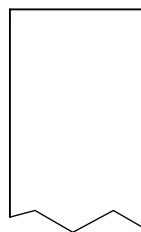
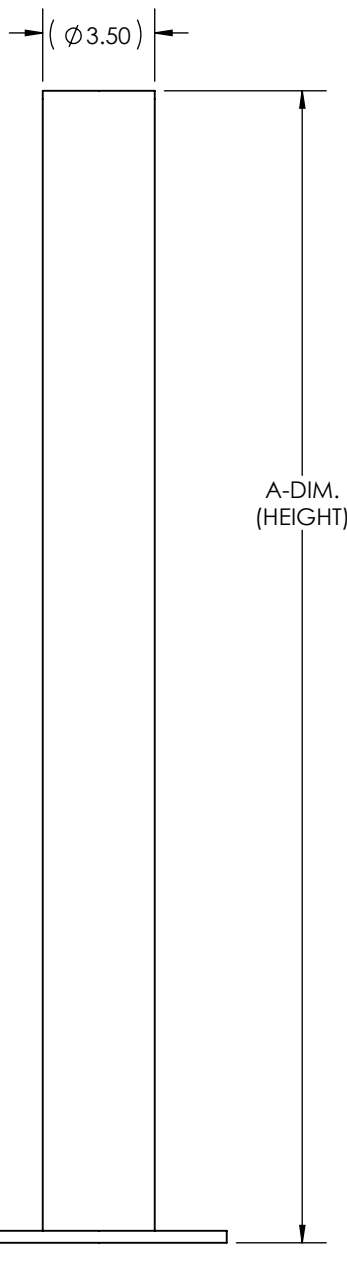

FLAT CAP

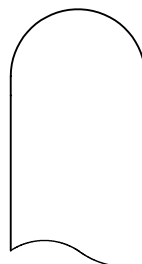

DOME CAP

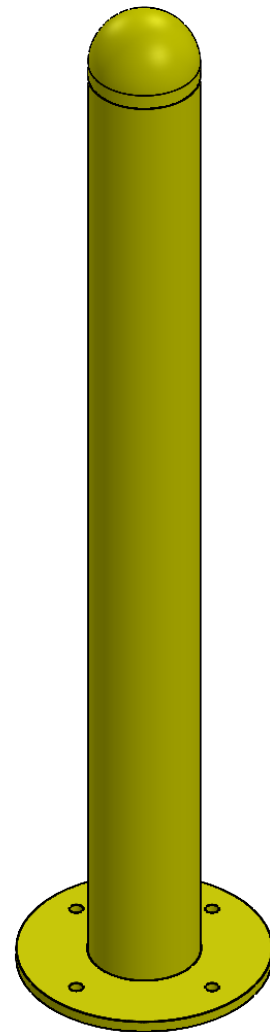

ZUMA BOLLARDS

A 7/12/22